A red leather massage chair is shown from a side-rear perspective. The chair has a high backrest and a wide seat. A semi-transparent orange overlay covers the right side and bottom of the image, creating a modern, minimalist aesthetic. The text is centered in the white area on the left.

USER GUIDE FOR MASSAGE CHAIR

CONTENT

Assembly Instruction	01-02
Program Coin/Bill Acceptor Massage Chair.....	03-04
Style of Massage	05
Safety Instructions	06-08
Troubleshooting	09
Parts List	10
Parts Name	11-12
Reflexology Chart	13
Acupressure Chart	14
Warranty	15

Assembly Instruction

Place ① chair-back on the floor with the front face up. Push down ② seat-frame to connect the two shaft-pins at the upper-rear, to the two claws at the left and right sides of the chair-back.

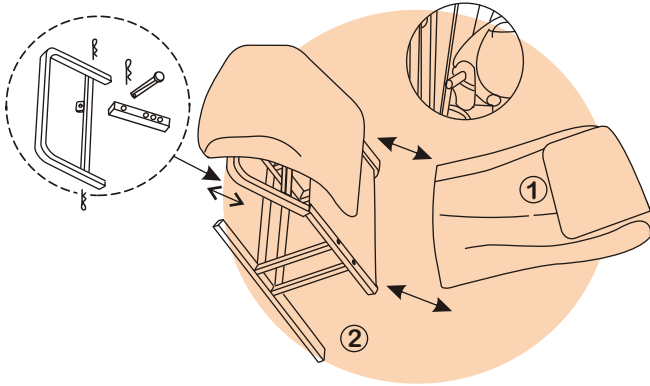

Remove the two R-pins from the chair back, and center clevis pin from the chair frame. Insert the clevis pin through the frame underneath the seat and insert the R-pin to secure. Decide preferred backrest posture, choose respective hole on the position bar.

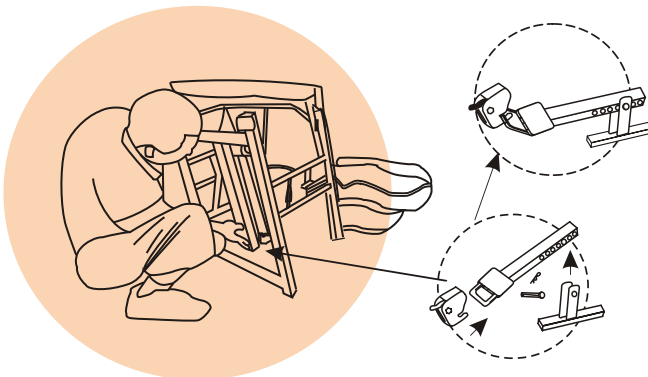

Line up and insert the prongs on the inner side of the ④ armrest into holes at the edge of the ② seat-frame. Attach the wing nut to the lowest prong and hand tighten it.

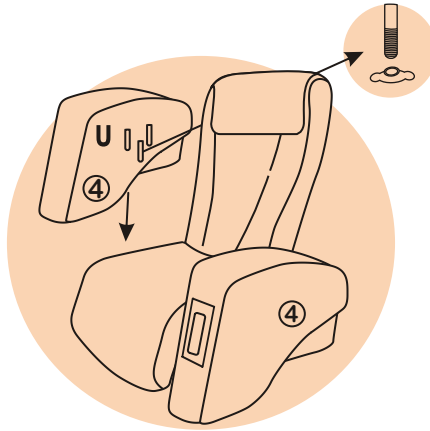

Connect the ① two wire connectors at the back and money arm, match the male and female connectors. Connect the ② two vibration wire connectors, match the male and female connectors. Connect the ③ two beeper wire connectors, match the male and female connectors.

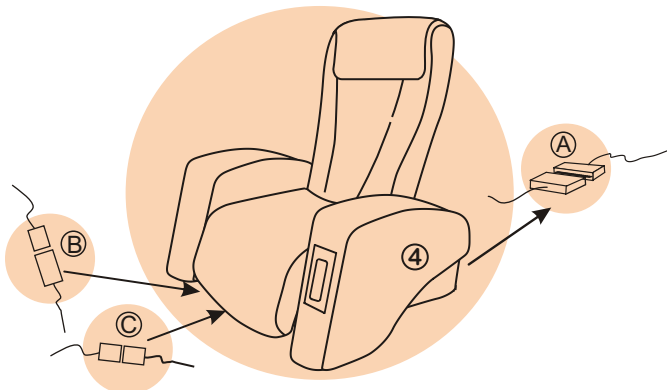

Program Coin/Bill Acceptor Massage Chair

With the armrest open, you would be able to view the back of the timer PC board. There are four small black round buttons at the back of the timer PC board. The button on the left is KEY1, and next as KEY2, KEY3, and KEY4.

These four buttons are for setting the massage time, the \$/units required for a massage session, the speaker volume, and the interval time of repeating beeping alarm to non-paying patron.

Massage "Time" Setup Procedure: F0

Press KEY1, F0 will appear on the LED display indicating the board is in setting mode.

Press KEY4, current setting of session/duration will display.

Press KEY2 to increase or KEY 3 to decrease minutes of allowing massage time.(1-20)

Press KEY4 to confirm the new setting, FO will appear on the LED display.

Press KEY1 to end setup.

Required "\$" For Massage Setup Procedure: F1

Press KEY1, F0 will appear on the LED display indicating the board is in setting mode.

Press KEY2, F1 will appear on the LED display indicating the board is ready to accept new setting.

Press KEY4, current setting of \$/unit will display.

Press KEY2 to increase or KEY3 to decrease required \$/unit.(1~20)

Press KEY4 to confirm the new setting, F1 will appear on the LED display.

Press KEY1 to end setup.

“Speaker Volume” Setup Procedure: F2

Press KEY1, F0 will appear on the LED display indicating the board is in setting mode.

Press KEY2, and ignore the F1 sign indicating the board ready to change \$/units setting.

Press KEY2, F2 will appear on the LED display indicating the board is ready to accept new setting.

Press KEY4, current setting of speaker volume will display.

Press KEY2 to increase or KEY3 to decrease speaker volume.(0~8)

Press KEY4 to confirm the new setting, F2 will appear on the LED display.

Press KEY1 to end setup.

“Beeper Interval” To Non-Paying Patron: F3

Press KEY1, F0 will appear on the LED display indicating the board is in setting mode.

Press KEY2, and ignore the F1 sign indicating the board ready to change \$/units setting.

Press KEY2, and ignore the F2 sign indicating the board ready to change speaker volume.

Press KEY2, F3 will appear on the LED display indicating the board is ready to accept new setting.

Press KEY4, current setting of speaker volume will display.

Press KEY2 to increase or KEY3 to decrease interval time.(1~99 sec)

Press KEY4 to confirm the new setting, F3 will appear on the LED display.

Press KEY1 to end setup.

In sum, F0=message time, F1=\$/units required, F2=speaker volume, F3-interval for repeat beeping.

Style of Massage

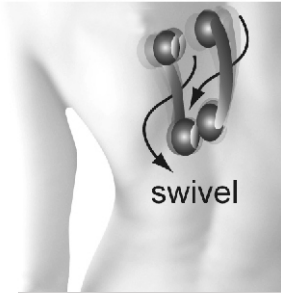

swivel

S MOTION:

Simulates palms, thumbs and/or fingers apply circular pressures which known as friction massage to penetrate deeper layers of muscles and tendons.



kneading

KNEADING:

Simulates kneading movements with hands, with thumbs and/or fingers which known as petrissage. An intense stretching technique to relieve soreness, release knots, improve circulation, revitalize muscles and tissues.

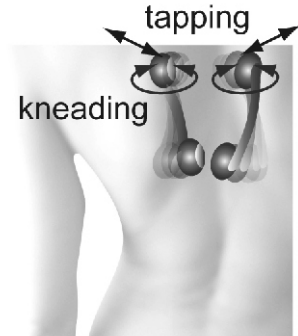

kneading

tapping

TAP-KNEADING:

Combine both kneading and tapping technique to stimulate, rejuvenate, relieve soreness and knots to revitalize muscles and tissues.

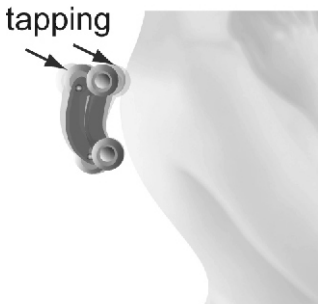

tapping

TAPPING:

Simulates brisk hacking or tapping movement, which known as percussion that stimulate and rejuvenate muscles.



rolling

ROLLING:

Massage begins with the up and down motion which known as effleurage, simulating gliding strokes with the palms, thumbs and/or fingertips to warm up and loosen muscles for deep therapeutic massage while relieving tension.

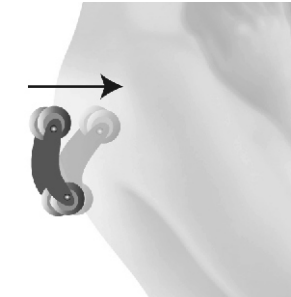

3D MESSAGE:

No other action than stretching is able to effectively relieve tiredness, the stretching action exercise both spinal cord and contracted muscles.

Safety Instructions

Use the chair with basic precautions, lift back-pad prior to use in order to check all materials are in good condition.

Else, unplug power and send for repair.

If any material is found torn, contact your local dealer for instructions and replacement.

Improper connection of the equipment-grounding conductor can result in risk of electric shock, check with qualified electrician or serviceman if in doubt.

Have the power outlet installed by qualified electrician if the plug does not fit.

DO NOT modify the provided plug.

DO NOT wind any cords around remote control to prevent possible electric shock or cause fire.

DO NOT allow children to use, play on or around it.

DO NOT stand on arm-rest, foot-rest or back-rest to avoid falling over.

DO NOT suddenly release hand while raising the foot-rest with hand.

Safety Precautions

Attention:

DO NOT USE THE CHAIR IF THE FABRIC IS TORN OR NOT IN GOOD CONDITION.

If the supply cord is damaged, it must be replaced by a special cord or assembly available from the manufacturer or its service agent.

EUT shall operate correctly in normal use under the following condition.

- A) An ambient temperature range of +10 to +40.
- B) A relative humidity range of 30% to 75%.
- C) An atmospheric range of 700 hpa to 1060 hpa.

Before Use

- A.** Place chair on flat and solid ground close to a power outlet with good grounding.
- B.** Follow user guide to assemble all parts and ensure complete setup.
- C.** Make sure power switch is at “OFF” position, the power switch is at the back of the chair.
- D.** Keep wire away from heater, do not share power point or extension wire with another electrical appliance.
- E.** Avoid blocking airway, do not put any item on the chair.

We recommend you to wear loose and comfortable clothes, no collar, no wristband, do not put any solid object in pocket.

For one with any of the following condition, consult doctor before use:

- 1.** Feel sick or wounded.
- 2.** Heart disease patient.
- 3.** Cancer or Tumor patient.
- 4.** Pregnant or during menstrual period.
- 5.** Spinal cord abnormal, bent or bone disease.
- 6.** Neural disease, paraplegic (apoplexy), cripple, weak and mental disordered.
- 7.** After meal or drastic sport.
- 8.** Children under 18 years old.
- 9.** Those with medical electronic device implanted.
- 10.** Serious blood circulation disorder in the legs.

In Use

- A.** Move all items away from the chair.
- B.** Never use this chair to massage head, face, hands, elbows, knees, and abdomen.
- C.** 15 minutes of massage time is recommended, avoid using longer than 30 minutes per session, and not longer than 3 minutes massage at one single position.
- D.** Stop using immediately if feel uncomfortable.
- E.** Ensure close supervision when use by or near to children or disabled persons. Ensure no-one or any pets around are near by before reclining the back-rest as to prevent injury.
- F.** Never operate with damaged cord or plug, keep cord from heated surface.
- G.** Never insert hand or foot between and underside of back-rest, arm-rest and seat.

After Use

- A.** Restore the chair-back upright, fold up the foot rest.
- B.** Do not place the chair under direct sunlight, close to heater, dusty place, and bathroom or moisture place.
- C.** Do not disassemble the chair; Maintenance and fixing are only to be taken care by authorized person.
- D.** Always unplug the chair from electrical outlet immediately after using and before cleaning.

Troubleshooting

Problem	Check For
A) No Power	Make sure chair is plugged in. Make sure the main power switch is on. Check the fuse and replace if burned out (fuse location is below red main power button).
B) Seat vibration	Check the 'Vibration' wire connector underneath chair.
C) Chair is operating erratically	Reset chair by 1) turning off the power on the main switch on chair 2) unplug the power cord. Allow to remain off for at least 10 minutes. Then power the chair back on by reversing this sequence.

Parts List

01 Back Pad	58 Spine Remedy Sliding Bracket
02 Back Plastic Cover	59 Bottom Bearing Bracket
03 Back Shell with Fabric	64 Footrest Metal Frame
04 Claws	65 Base Pad
06 Caster Wheel	67 Pillow
07 Armrest,Left	69 Tapping Motor
09 Locating Sleeve for Armrest	70 Kneading Motor
10 Prong	
11 Armrest, Right	
13 Pin	
14 Segment(split)/Cotter Pin	
19 Power Cord	
21 Power Supply Switch Box	
27 Seat Cushion	
30 Bearing Bracket	
32 U-groved Bar	
33 Driving Shaft	
34 Upper Limit Switch	
35 Lubrication Box	
36 Guide Wheel	
37 PCB	
39 Lower Limit Switch	
40 Driving Motor	
41 Chair-back Bottom Cover	
42 Belt	
44 Signal Sensor	
47 Massage Arm	
49 Massage Roller	
50 Massage Unit	
55 Transformer	
57 Fixed Supporting Rollers	

Parts Name

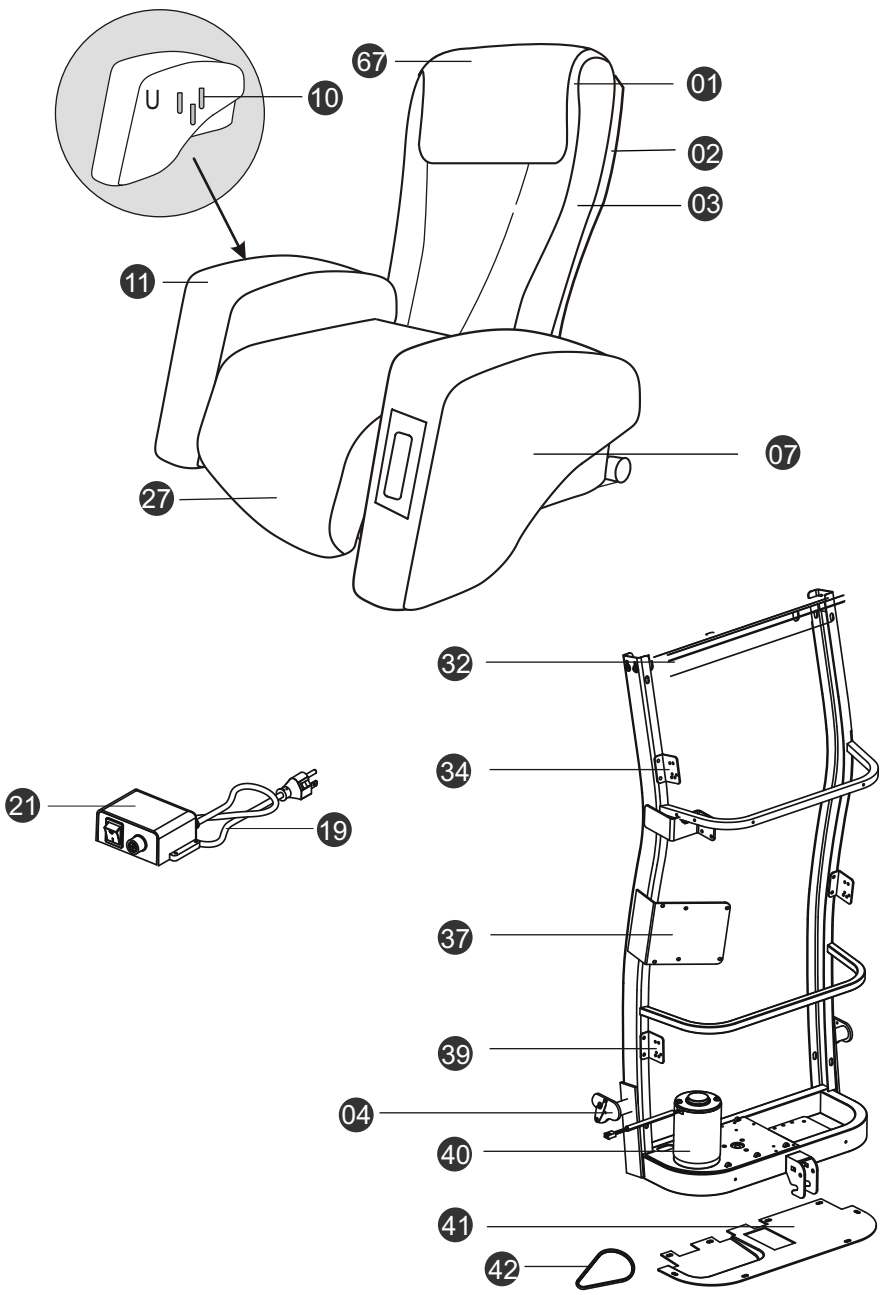

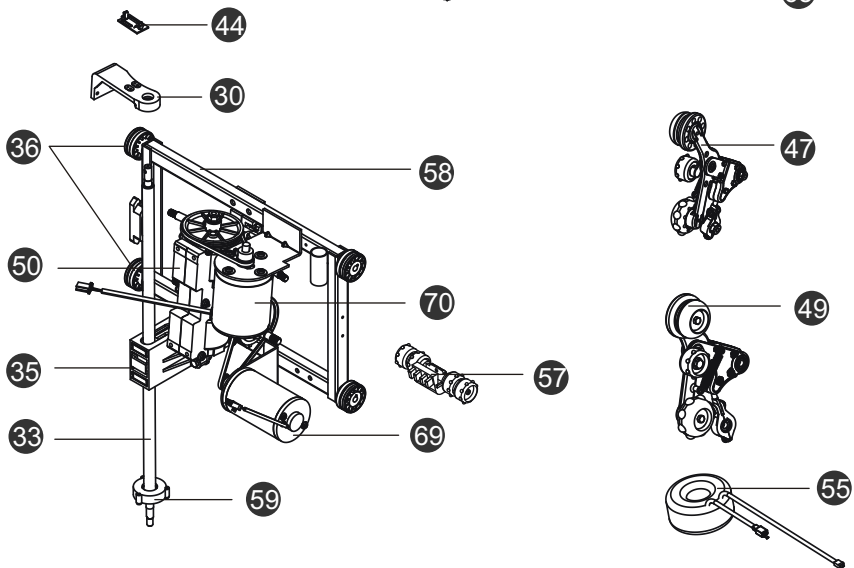
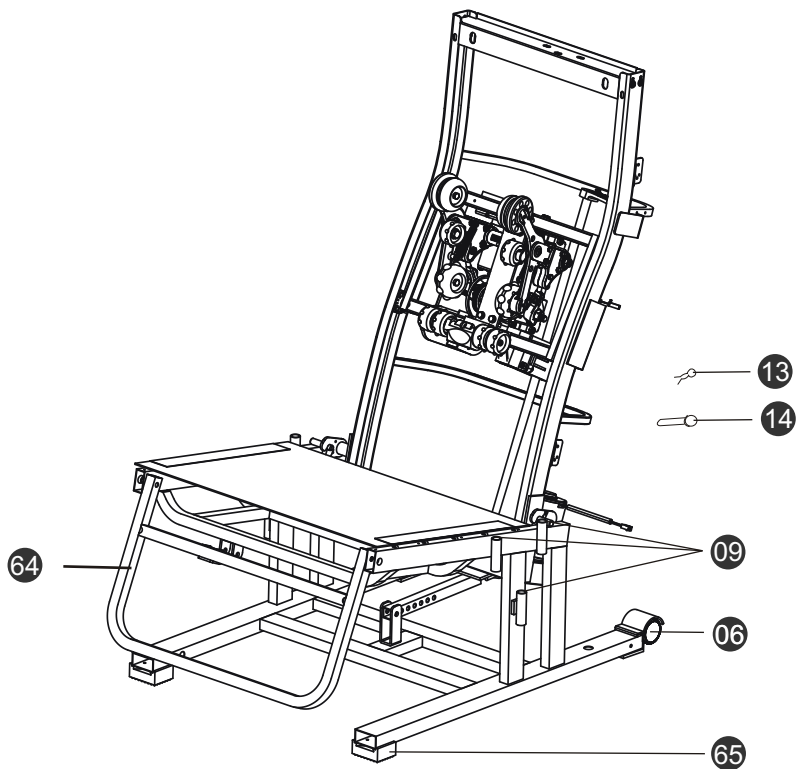

Reflexology Chart

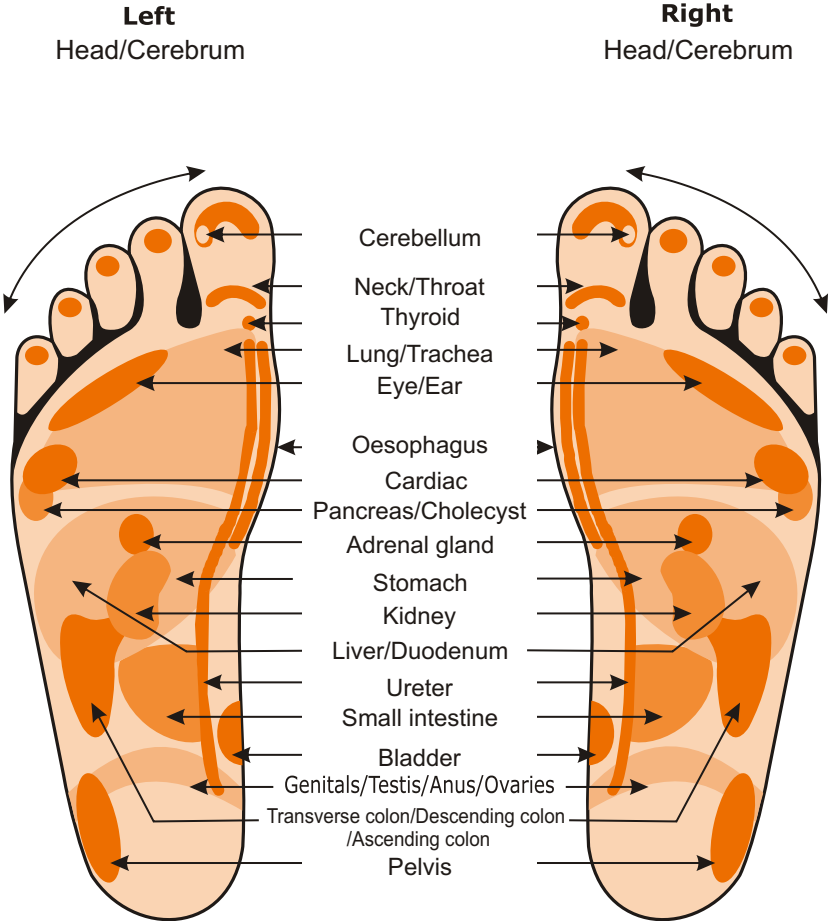

Acupressure Chart

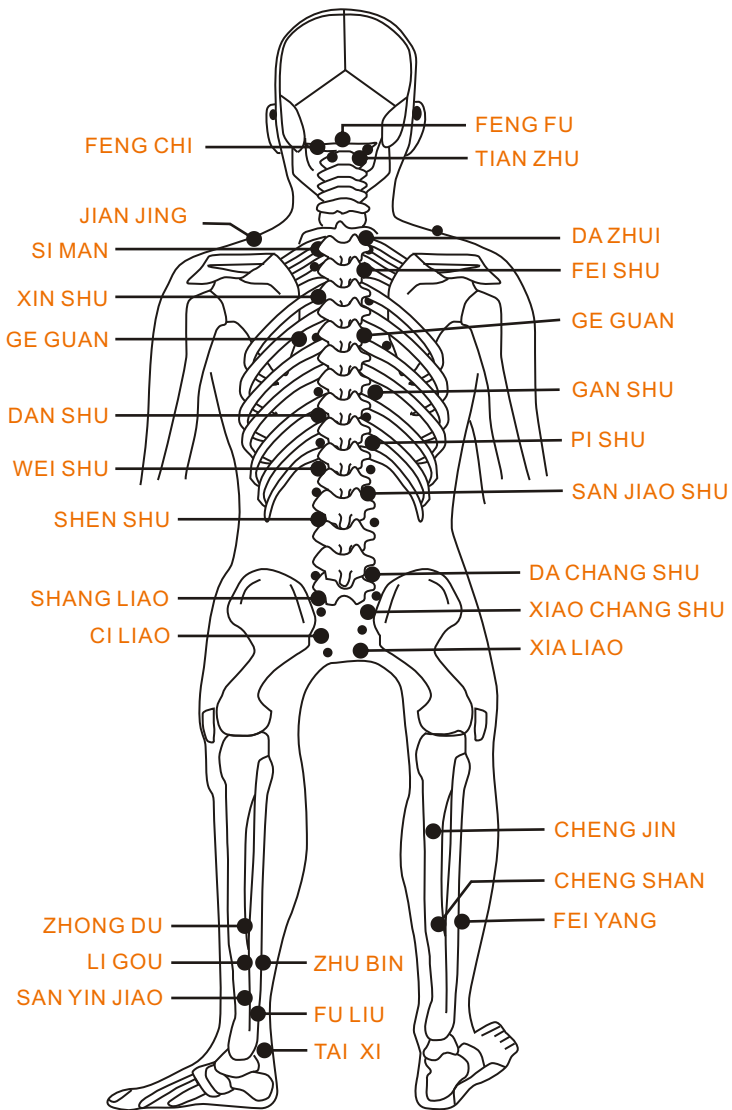



Warranty

1. 6 months warranty from date of purchase, if the chair does not work under normal use.
2. May present this warranty card after warranty period for discount.
3. Warranty void if filled with false information.
4. Will be charged under any one of the following conditions, even it is under warranty period.
 - Unable to present this warranty card.
 - Damage caused by disassemble or repaired by unauthorised person or under abnormal use.
 - Damage caused by storm, earthquake or power surged.
5. This warranty card applicable only to massage chair. Will be charged if additional service required.
6. Please contact your dealer or distributor for any problem. Do not try to fix or disassemble yourself.
7. Thank you very much for purchasing this product.